



RESIDENCE

70 Osprey Drive, Uddingston, G71 6HZ

www.residenceestateagents.co.uk



Viewing by appointment with Residence Uddingston

T: 01698 444222 | E: uddingston@residencestateagents.co.uk | A: 61-63 Main Street, Uddingston, G71 7EP



RESIDENCE





3 Bedrooms | 1 Public Rooms | 1 Bathrooms

This modern, three-bedroom semi-detached villa is sure to be popular with families or first-time buyers. Situated in the highly desirable Spindlehowe area of Uddingston, it offers a perfect blend of comfort and convenience.

The accommodation comprises an inviting entrance hallway with stairs leading to the upper floor, a spacious lounge with front-facing aspects, and an open-plan formal dining area. Double-glazed French doors from the dining space open onto the rear gardens, creating a seamless indoor-outdoor flow. The modern fitted kitchen features a range of base and wall-mounted storage units, worktop surfaces, space for white goods, and a side-facing window along with a rear door providing access to the garden.

Upstairs, you'll find three bedrooms and a modern family bathroom with a three-piece suite.

Additional features include gas central heating, double glazing throughout, a driveway for off-street parking, and maintained gardens with patios, a lawn, a shed, and fencing for privacy and security at the rear.

Early viewing is highly recommended to appreciate this outstanding property.

Uddingston is renowned for its vibrant main street, offering a wide range of shops to meet everyday needs, as well as a great selection of restaurants, bistros, and pubs. The area is within popular school catchments and benefits from excellent public transport links, including regular bus and train services to nearby towns, Glasgow, and Edinburgh. Major motorways, such as the M74 and M8, provide quick access to the Central Belt, connecting you effortlessly to surrounding towns and cities. The area also boasts a wealth of leisure facilities, including golf courses, swimming pools, gyms, and picturesque country parks with scenic walks.



839.58 sq ft | EER = D



RESIDENCE







Osprey Drive

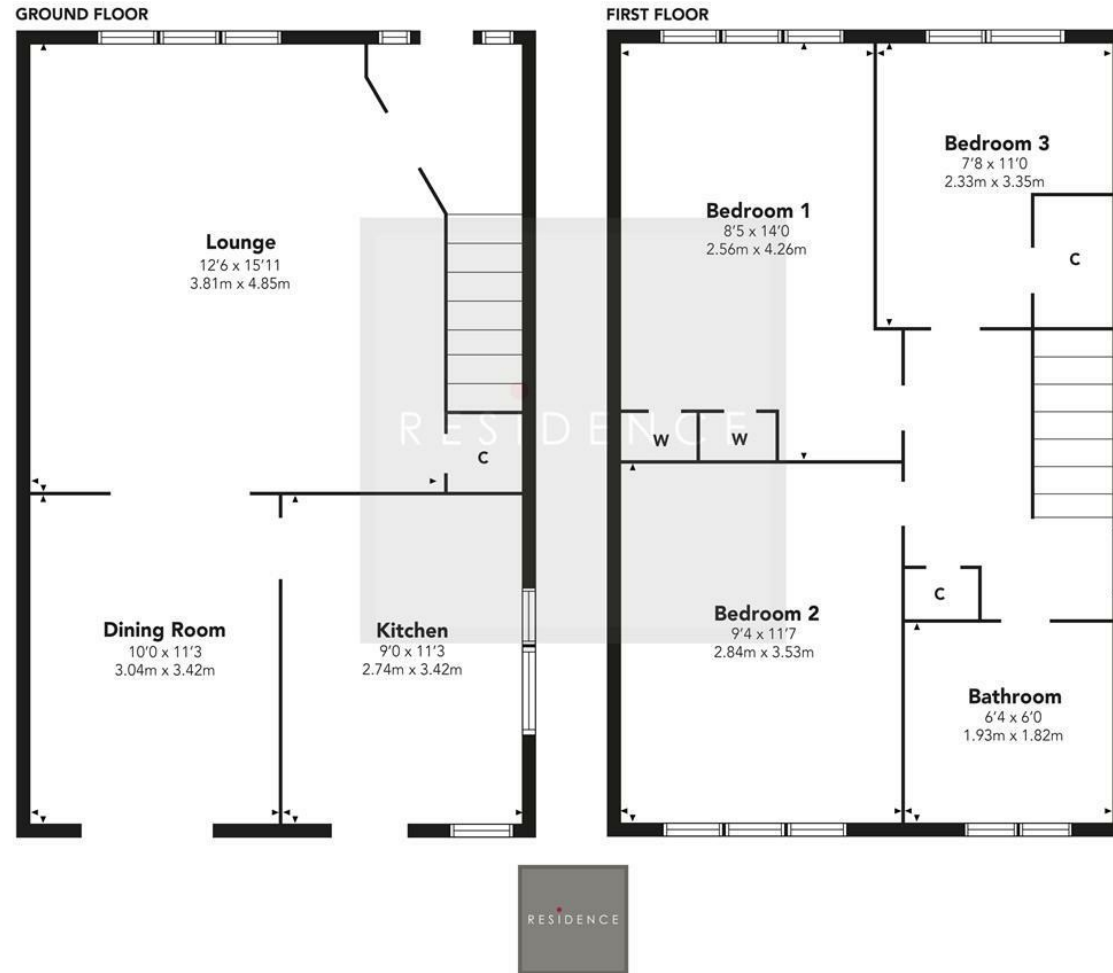

Floor Plan measurements are approximate and are for illustrative purposes only.
While we do not doubt the floor plans accuracy, we make no guarantee, warranty or representation as to the accuracy and completeness of the floor plan. You or your advisors should conduct a careful, independent investigation of the property to determine to your satisfaction as to the suitability of the property for your space requirements.
Produced by Plush Plans Ltd

We believe these details to be accurate; however, they do not form any part of a contract. Fixtures and fittings are not included unless specified in the enclosed. Photographs are for general information and it must not be inferred that any item is included for sale with the property. All distances and measurements are approximate. Floorplans may not be to scale and are for illustration purposes only.